

NO	Název	Materiál	Délka [m]
IO 01.1	Stoka A	PVC DN 250 SN 12	234,2
IO 01.2	Stoka A	PVC DN 250 SN 12	797,7
IO 01.3	Stoka A.1	PVC DN 250 SN 12	185,7
IO 01.4	Stoka A.2	PVC DN 250 SN 12	48,1
IO 01.5	Stoka A.3	PVC DN 250 SN 12	202,2
IO 01.6	Stoka B	PVC DN 250 SN 12	134,4
IO 01.7	Stoka B.1	PVC DN 250 SN 12	68,8
IO 01.8	Stoka B.2	PVC DN 250 SN 12	286,1
IO 01.9	Stoka B.3	PVC DN 250 SN 12	162,9
IO 01.10	Stoka B.4	PVC DN 250 SN 12	222,2
IO 01.11	Stoka C	PVC DN 250 SN 12	134,4
IO 01.12	Stoka C	PVC DN 250 SN 12	247,1
IO 01.13	Stoka A.4	PVC DN 250 SN 12	134,4
IO 01.14	Stoka B.4	PVC DN 250 SN 12	134,4
IO 01.15	Stoka A.4	PVC DN 250 SN 12	134,4
IO 01.16	Stoka B.4	PVC DN 250 SN 12	134,4
IO 01.17	Stoka C.4	PVC DN 250 SN 12	134,4
IO 01.18	Stoka A.4	PVC DN 250 SN 12	134,4
IO 01.19	Stoka B.4	PVC DN 250 SN 12	134,4
IO 01.20	Stoka C.4	PVC DN 250 SN 12	134,4
IO 01.21	Stoka A.4	PVC DN 250 SN 12	134,4
IO 01.22	Stoka B.4	PVC DN 250 SN 12	134,4
IO 01.23	Stoka C.4	PVC DN 250 SN 12	134,4
IO 01.24	Stoka A.4	PVC DN 250 SN 12	134,4
IO 01.25	Stoka B.4	PVC DN 250 SN 12	134,4
IO 01.26	Stoka C.4	PVC DN 250 SN 12	134,4
IO 01.27	Stoka A.4	PVC DN 250 SN 12	134,4
IO 01.28	Stoka B.4	PVC DN 250 SN 12	134,4
IO 01.29	Stoka C.4	PVC DN 250 SN 12	134,4
IO 01.30	Stoka A.4	PVC DN 250 SN 12	134,4
IO 01.31	Stoka B.4	PVC DN 250 SN 12	134,4
IO 01.32	Stoka C.4	PVC DN 250 SN 12	134,4
IO 01.33	Stoka A.4	PVC DN 250 SN 12	134,4
IO 01.34	Stoka B.4	PVC DN 250 SN 12	134,4
IO 01.35	Stoka C.4	PVC DN 250 SN 12	134,4
IO 01.36	Stoka A.4	PVC DN 250 SN 12	134,4
IO 01.37	Stoka B.4	PVC DN 250 SN 12	134,4
IO 01.38	Stoka C.4	PVC DN 250 SN 12	134,4
IO 01.39	Stoka A.4	PVC DN 250 SN 12	134,4
IO 01.40	Stoka B.4	PVC DN 250 SN 12	134,4
IO 01.41	Stoka C.4	PVC DN 250 SN 12	134,4
IO 01.42	Stoka A.4	PVC DN 250 SN 12	134,4
IO 01.43	Stoka B.4	PVC DN 250 SN 12	134,4
IO 01.44	Stoka C.4	PVC DN 250 SN 12	134,4
IO 01.45	Stoka A.4	PVC DN 250 SN 12	134,4
IO 01.46	Stoka B.4	PVC DN 250 SN 12	134,4
IO 01.47	Stoka C.4	PVC DN 250 SN 12	134,4
IO 01.48	Stoka A.4	PVC DN 250 SN 12	134,4
IO 01.49	Stoka B.4	PVC DN 250 SN 12	134,4
IO 01.50	Stoka C.4	PVC DN 250 SN 12	134,4
IO 01.51	Stoka A.4	PVC DN 250 SN 12	134,4
IO 01.52	Stoka B.4	PVC DN 250 SN 12	134,4
IO 01.53	Stoka C.4	PVC DN 250 SN 12	134,4
IO 01.54	Stoka A.4	PVC DN 250 SN 12	134,4
IO 01.55	Stoka B.4	PVC DN 250 SN 12	134,4
IO 01.56	Stoka C.4	PVC DN 250 SN 12	134,4
IO 01.57	Stoka A.4	PVC DN 250 SN 12	134,4
IO 01.58	Stoka B.4	PVC DN 250 SN 12	134,4
IO 01.59	Stoka C.4	PVC DN 250 SN 12	134,4
IO 01.60	Stoka A.4	PVC DN 250 SN 12	134,4
IO 01.61	Stoka B.4	PVC DN 250 SN 12	134,4
IO 01.62	Stoka C.4	PVC DN 250 SN 12	134,4
IO 01.63	Stoka A.4	PVC DN 250 SN 12	134,4
IO 01.64	Stoka B.4	PVC DN 250 SN 12	134,4
IO 01.65	Stoka C.4	PVC DN 250 SN 12	134,4
IO 01.66	Stoka A.4	PVC DN 250 SN 12	134,4
IO 01.67	Stoka B.4	PVC DN 250 SN 12	134,4
IO 01.68	Stoka C.4	PVC DN 250 SN 12	134,4
IO 01.69	Stoka A.4	PVC DN 250 SN 12	134,4
IO 01.70	Stoka B.4	PVC DN 250 SN 12	134,4
IO 01.71	Stoka C.4	PVC DN 250 SN 12	134,4
IO 01.72	Stoka A.4	PVC DN 250 SN 12	134,4
IO 01.73	Stoka B.4	PVC DN 250 SN 12	134,4
IO 01.74	Stoka C.4	PVC DN 250 SN 12	134,4
IO 01.75	Stoka A.4	PVC DN 250 SN 12	134,4
IO 01.76	Stoka B.4	PVC DN 250 SN 12	134,4
IO 01.77	Stoka C.4	PVC DN 250 SN 12	134,4
IO 01.78	Stoka A.4	PVC DN 250 SN 12	134,4
IO 01.79	Stoka B.4	PVC DN 250 SN 12	134,4
IO 01.80	Stoka C.4	PVC DN 250 SN 12	134,4
IO 01.81	Stoka A.4	PVC DN 250 SN 12	134,4
IO 01.82	Stoka B.4	PVC DN 250 SN 12	134,4
IO 01.83	Stoka C.4	PVC DN 250 SN 12	134,4
IO 01.84	Stoka A.4	PVC DN 250 SN 12	134,4
IO 01.85	Stoka B.4	PVC DN 250 SN 12	134,4
IO 01.86	Stoka C.4	PVC DN 250 SN 12	134,4
IO 01.87	Stoka A.4	PVC DN 250 SN 12	134,4
IO 01.88	Stoka B.4	PVC DN 250 SN 12	134,4
IO 01.89	Stoka C.4	PVC DN 250 SN 12	134,4
IO 01.90	Stoka A.4	PVC DN 250 SN 12	134,4
IO 01.91	Stoka B.4	PVC DN 250 SN 12	134,4
IO 01.92	Stoka C.4	PVC DN 250 SN 12	134,4
IO 01.93	Stoka A.4	PVC DN 250 SN 12	134,4
IO 01.94	Stoka B.4	PVC DN 250 SN 12	134,4
IO 01.95	Stoka C.4	PVC DN 250 SN 12	134,4
IO 01.96	Stoka A.4	PVC DN 250 SN 12	134,4
IO 01.97	Stoka B.4	PVC DN 250 SN 12	134,4
IO 01.98	Stoka C.4	PVC DN 250 SN 12	134,4
IO 01.99	Stoka A.4	PVC DN 250 SN 12	134,4
IO 02.00	Stoka B.4	PVC DN 250 SN 12	134,4

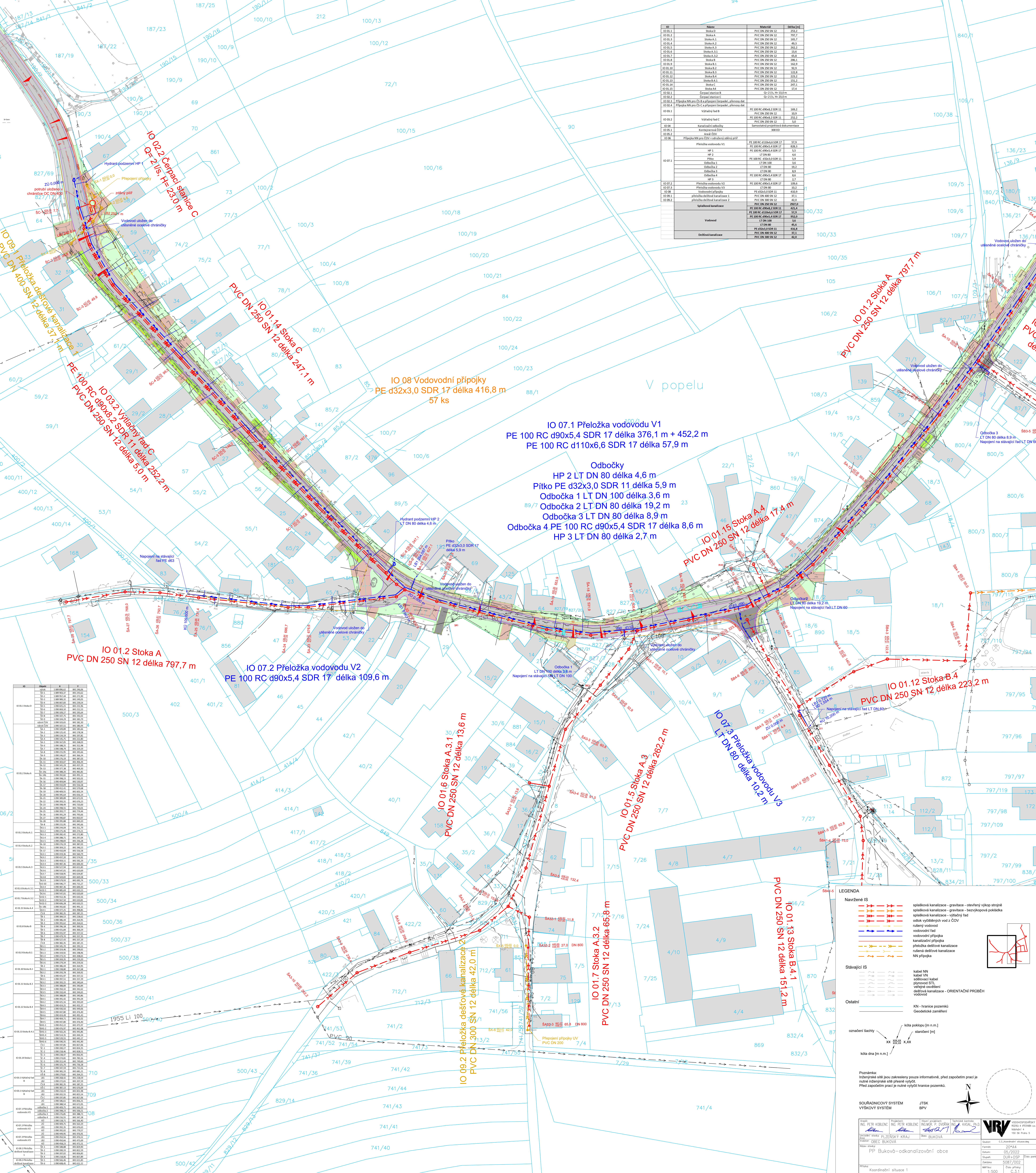

NO	Název	X	Y
IO 01.1	Stoka A	1000000.00	1000000.00
IO 01.2	Stoka A	1000000.00	1000000.00
IO 01.3	Stoka A.1	1000000.00	1000000.00
IO 01.4	Stoka A.2	1000000.00	1000000.00
IO 01.5	Stoka A.3	1000000.00	1000000.00
IO 01.6	Stoka B	1000000.00	1000000.00
IO 01.7	Stoka B.1	1000000.00	1000000.00
IO 01.8	Stoka B.2	1000000.00	1000000.00
IO 01.9	Stoka B.3	1000000.00	1000000.00
IO 01.10	Stoka B.4	1000000.00	1000000.00
IO 01.11	Stoka C	1000000.00	1000000.00
IO 01.12	Stoka C	1000000.00	1000000.00
IO 01.13	Stoka A.4	1000000.00	1000000.00
IO 01.14	Stoka B.4	1000000.00	1000000.00
IO 01.15	Stoka A.4	1000000.00	1000000.00
IO 01.16	Stoka B.4	1000000.00	1000000.00
IO 01.17	Stoka C.4	1000000.00	1000000.00
IO 01.18	Stoka A.4	1000000.00	1000000.00
IO 01.19	Stoka B.4	1000000.00	1000000.00
IO 01.20	Stoka C.4	1000000.00	1000000.00
IO 01.21	Stoka A.4	1000000.00	1000000.00
IO 01.22	Stoka B.4	1000000.00	1000000.00
IO 01.23	Stoka C.4	1000000.00	1000000.00
IO 01.24	Stoka A.4	1000000.00	1000000.00
IO 01.25	Stoka B.4	1000000.00	1000000.00
IO 01.26	Stoka C.4	1000000.00	1000000.00
IO 01.27	Stoka A.4	1000000.00	1000000.00
IO 01.28	Stoka B.4	1000000.00	1000000.00
IO 01.29	Stoka C.4	1000000.00	1000000.00
IO 01.30	Stoka A.4	1000000.00	1000000.00
IO 01.31	Stoka B.4	1000000.00	1000000.00
IO 01.32	Stoka C.4	1000000.00	1000000.00
IO 01.33	Stoka A.4	1000000.00	1000000.00
IO 01.34	Stoka B.4	1000000.00	1000000.00
IO 01.35	Stoka C.4	1000000.00	1000000.00
IO 01.36	Stoka A.4	1000000.00	1000000.00
IO 01.37	Stoka B.4	1000000.00	1000000.00
IO 01.38	Stoka C.4	1000000.00	1000000.00
IO 01.39	Stoka A.4	1000000.00	1000000.00
IO 01.40	Stoka B.4	1000000.00	1000000.00
IO 01.41	Stoka C.4	1000000.00	1000000.00
IO 01.42	Stoka A.4	1000000.00	1000000.00
IO 01.43	Stoka B.4	1000000.00	1000000.00
IO 01.44	Stoka C.4	1000000.00	1000000.00
IO 01.45	Stoka A.4	1000000.00	1000000.00
IO 01.46	Stoka B.4	1000000.00	1000000.00
IO 01.47	Stoka C.4	1000000.00	1000000.00
IO 01.48	Stoka A.4	1000000.00	1000000.00
IO 01.49	Stoka B.4	1000000.00	1000000.00
IO 01.50	Stoka C.4	1000000.00	1000000.00
IO 01.51	Stoka A.4	1000000.00	1000000.00
IO 01.52	Stoka B.4	1000000.00	1000000.00
IO 01.53	Stoka C.4	1000000.00	1000000.00
IO 01.54	Stoka A.4	1000000.00	1000000.00
IO 01.55	Stoka B.4	1000000.00	1000000.00
IO 01.56	Stoka C.4	1000000.00	1000000.00
IO 01.57	Stoka A.4	1000000.00	1000000.00
IO 01.58	Stoka B.4	1000000.00	1000000.00
IO 01.59	Stoka C.4	1000000.00	1000000.00
IO 01.60	Stoka A.4	1000000.00	1000000.00
IO 01.61	Stoka B.4	1000000.00	1000000.00
IO 01.62	Stoka C.4	1000000.00	1000000.00
IO 01.63	Stoka A.4	1000000.00	1000000.00
IO 01.64	Stoka B.4	1000000.00	1000000.00
IO 01.65	Stoka C.4	1000000.00	1000000.00
IO 01.66	Stoka A.4	1000000.00	1000000.00
IO 01.67	Stoka B.4	1000000.00	1000000.00
IO 01.68	Stoka C.4	1000000.00	1000000.00
IO 01.69	Stoka A.4	1000000.00	1000000.00
IO 01.70	Stoka B.4	1000000.00	1000000.00
IO 01.71	Stoka C.4	1000000.00	1000000.00
IO 01.72	Stoka A.4	1000000.00	1000000.00
IO 01.73	Stoka B.4	1000000.00	1000000.00
IO 01.74	Stoka C.4	1000000.00	1000000.00
IO 01.75	Stoka A.4	1000000.00	1000000.00
IO 01.76	Stoka B.4	1000000.00	1000000.00
IO 01.77	Stoka C.4	1000000.00	1000000.00
IO 01.78	Stoka A.4	1000000.00	1000000.00
IO 01.79	Stoka B.4	1000000.00	1000000.00
IO 01.80	Stoka C.4	1000000.00	1000000.00
IO 01.81	Stoka A.4	1000000.00	1000000.00
IO 01.82	Stoka B.4	1000000.00	1000000.00
IO 01.83	Stoka C.4	1000000.00	1000000.00
IO 01.84	Stoka A.4	1000000.00	1000000.00
IO 01.85	Stoka B.4	1000000.00	1000000.00
IO 01.86	Stoka C.4	1000000.00	1000000.00
IO 01.87	Stoka A.4	1000000.00	1000000.00
IO 01.88	Stoka B.4	1000000.00	1000000.00
IO 01.89	Stoka C.4	1000000.00	1000000.00
IO 01.90	Stoka A.4	1000000.00	1000000.00
IO 01.91	Stoka B.4	1000000.00	1000000.00
IO 01.92	Stoka C.4	1000000.00	1000000.00
IO 01.93	Stoka A.4	1000000.00	1000000.00
IO 01.94	Stoka B.4	1000000.00	1000000.00
IO 01.95	Stoka C.4	1000000.00	1000000.00
IO 01.96	Stoka A.4	1000000.00	1000000.00
IO 01.97	Stoka B.4	1000000.00	1000000.00
IO 01.98	Stoka C.4	1000000.00	1000000.00
IO 01.99	Stoka A.4	1000000.00	1000000.00
IO 02.00	Stoka B.4	1000000.00	1000000.00

LEGENDA

Navržené IS

- spíšková kanalizace - gravitace - otevřený výkop strojně
- spíšková kanalizace - gravitace - bezvýkopové pokladky
- spíšková kanalizace - výhledový řad
- odtok vyhledávaných vod z ČOV
- rubový vodovod
- vodovodní řad
- vodovodní přípojka
- kanalizační přípojka
- příloha dešťové kanalizace
- rušená dešťová kanalizace
- NN přípojka

Stávající IS

- kabel NN
- kabel VN
- síťovací kabel
- přívodní STL
- veřejné osvětlení
- dešťová kanalizace - ORIENTAČNÍ PŘEBĚH
- vodovod

Ostatní

- KV - hranice pozemků
- Geodetické zaměření

označení šachty

- kóta pokropu [m n.m.]
- stavení [m]